

**Estratto** Catalogo Listino 01/2025

# Gamma **PP-Random** GREENTHERM POLYMELT ECOSAN POLYMELT MECHANICAL

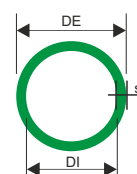

SDR 6.0 Tubo **GREENTHERM** monostrato

Codice	Aspetto e L mm.	DN/DE mm.	DI mm.	Sp. mm.	Peso Kg./mt.	Conf. mt.	€/Mt.
VTU20000	Barra VERDE / 4000	20	13,2	3,4	0,176	100	<b>1,55</b>
VTU25000	Barra VERDE / 4000	25	16,6	4,2	0,270	100	<b>2,45</b>
VTU32000	Barra VERDE / 4000	32	21,2	5,4	0,444	40	<b>4,50</b>
VTU40000	Barra VERDE / 4000	40	26,6	6,7	0,686	20	<b>7,40</b>
VTU50000	Barra VERDE / 4000	50	33,2	8,3	1,037	20	<b>11,70</b>
VTU63000	Barra VERDE / 4000	63	42,0	10,5	1,689	20	<b>18,20</b>
VTU75000	Barra VERDE / 4000	75	50,0	12,5	2,340	12	<b>27,00</b>
VTU90000	Barra VERDE / 4000	90	60,0	15,0	3,360	8	<b>41,00</b>
VTU11000	Barra VERDE / 4000	110	73,4	18,3	5,040	4	<b>61,00</b>
VTU20020	Barra VERDE / 3000	20	13,2	3,4	0,176	75	<b>1,55</b>
VTU25020	Barra VERDE / 3000	25	16,6	4,2	0,270	60	<b>2,45</b>

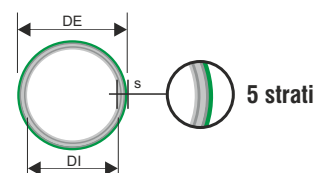
SDR 7.4 Tubo **POLYMELT ECOSAN ML5** strati con **PP-R CT**

Codice	Aspetto e L mm.	DN/DE mm.	DI mm.	Sp. mm.	Peso Kg./mt.	Conf. mt.	€/Mt.
VML52000 16322	Barra VERDE (RAL6024) / 4000	20	14,4	2,8	0,149	100	<b>2,60</b>
VML52500 16323	Barra VERDE (RAL6024) / 4000	25	18,0	3,5	0,236	60	<b>4,10</b>
VML53200 16324	Barra VERDE (RAL6024) / 4000	32	23,2	4,4	0,385	40	<b>7,20</b>
VML54000 16325	Barra VERDE (RAL6024) / 4000	40	29,0	5,5	0,584	20	<b>10,80</b>
VML55000 16326	Barra VERDE (RAL6024) / 4000	50	36,2	6,9	0,916	20	<b>17,00</b>
VML56300 16327	Barra VERDE (RAL6024) / 4000	63	45,8	8,6	1,474	12	<b>27,00</b>
VML57500 16328	Barra VERDE (RAL6024) / 4000	75	54,4	10,3	2,048	8	<b>38,50</b>
VML59000 16329	Barra VERDE (RAL6024) / 4000	90	65,4	12,3	2,922	4	<b>55,00</b>
VML51100 16330	Barra VERDE (RAL6024) / 4000	110	79,8	15,1	4,374	4	<b>83,00</b>
<input type="checkbox"/> VML51250 16331	Barra VERDE (RAL6024) / 4000	125	90,8	17,1	5,530	4	<b>112,00</b>
<input type="checkbox"/> VML51600 16342	Barra VERDE (RAL6024) / 4000	160	116,2	21,9	9,040	4	<b>180,00</b>
<input type="checkbox"/> VML50200 16343	Barra VERDE (RAL6024) / 4000	200	145,2	27,4	14,100	4	<b>279,00</b>
<input type="checkbox"/> VML50250 16344	Barra VERDE (RAL6024) / 4000	250	181,6	34,2	22,100	4	<b>432,00</b>

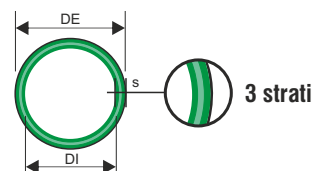
**SDR 7.4 Tubo GREENTHERM FASER UV Resistance a 3 strati**

Codice	Aspetto e L mm.	DN/DE mm.	DI mm.	Sp. mm.	Peso Kg./mt.	Conf. mt.	€/Mt.
<input type="checkbox"/> VTUV2000	Barra NERA / 4000	20	14,4	2,8	0,152	100	<b>A richiesta</b>
<input type="checkbox"/> VTUV2500	Barra NERA / 4000	25	18,0	3,5	0,236	100	<b>A richiesta</b>
<input type="checkbox"/> VTUV3200	Barra NERA / 4000	32	23,2	4,4	0,379	40	<b>A richiesta</b>
<input type="checkbox"/> VTUV4000	Barra NERA / 4000	40	29,0	5,5	0,584	32	<b>A richiesta</b>
<input type="checkbox"/> VTUV5000	Barra NERA / 4000	50	36,2	6,9	0,917	20	<b>A richiesta</b>
<input type="checkbox"/> VTUV6300	Barra NERA / 4000	63	45,8	8,6	1,442	12	<b>A richiesta</b>
<input type="checkbox"/> VTUV7500	Barra NERA / 4000	75	54,4	10,3	2,052	12	<b>A richiesta</b>
<input type="checkbox"/> VTUV9000	Barra NERA / 4000	90	65,4	12,3	2,939	8	<b>A richiesta</b>
<input type="checkbox"/> VTUV1100	Barra NERA / 4000	110	79,8	15,1	4,401	8	<b>A richiesta</b>

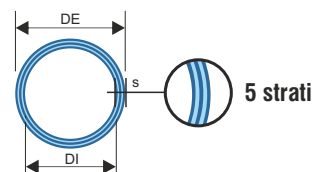
**SDR 11.0 Tubo POLYMELT MECHANICAL con fibre minerali a 5 strati**

Codice	Aspetto e L mm.	DN/DE mm.	DI mm.	Sp. mm.	Peso Kg./mt.	Acqua l./mt.	Conf. mt.	€/Mt.
VPK32000 80324	Barra BLU / 4000	32	26,2	2,9	0,260	0,53	40	<b>5,20</b>
VPK40000 80325	Barra BLU / 4000	40	32,6	3,7	0,410	0,83	20	<b>8,00</b>
VPK50000 80326	Barra BLU / 4000	50	40,8	4,6	0,640	1,31	20	<b>12,00</b>
VPK63000 80327	Barra BLU / 4000	63	51,4	5,8	1,010	2,08	12	<b>18,00</b>
VPK75000 80328	Barra BLU / 4000	75	61,4	6,8	1,410	2,94	8	<b>26,00</b>
VPK90000 80329	Barra BLU / 4000	90	73,6	8,2	2,030	4,25	4	<b>38,00</b>
VPK11000 80330	Barra BLU / 4000	110	90,0	10,0	3,010	6,36	4	<b>55,00</b>
<input type="checkbox"/> VPK12500 80331	Barra BLU / 4000	125	102,2	11,4	3,910	8,20	4	<b>66,00</b>
<input type="checkbox"/> VPK16000 80333	Barra BLU / 4000	160	130,8	14,6	6,380	13,44	4	<b>118,00</b>
<input type="checkbox"/> VPK20000 80334	Barra BLU / 4000	200	163,6	18,2	9,950	21,03	4	<b>185,00</b>
<input type="checkbox"/> VPK25000 80335	Barra BLU / 4000	250	204,6	22,7	15,500	32,87	4	<b>290,00</b>

## Gomito femmina a 90°

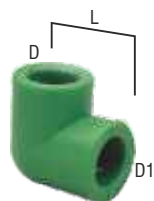

Codice	Ø DxD1 mm.	L mm.	Conf. Pezzi	Conf. Scatola	€/Pz.
VG920000	20x20	27,0	10	250	0,42
VG925000	25x25	32,0	10	140	0,68
VG932000	32x32	37,5	10	50	1,05
VG940000	40x40	44,5	1	30	2,52
VG950000	50x50	53,5	1	30	4,75
VG963000	63x63	63,0	1	10	9,80
VG975000	75x75	120,0	1	12	15,90
VG990000	90x90	142,0	1	5	28,00
VG911000	110x110	169,0	1	5	53,00
★ □ VG912500 17051	125x125	107,0	1	8	91,00
★ ○ □ VG916000 17053/2	160x160 SDR 11	117,0	1	1	180,00
★ ○ □ VG900200 17055/2	200x200 SDR 11	128,0	1	1	710,00
★ ○ □ VG900250 17057/2	250x250 SDR 11	180,0	1	1	997,00

## Gomito femmina a 45°



Codice	Ø DxD1 mm.	L mm.	Conf. Pezzi	Conf. Scatola	€/Pz.
VG420000	20x20	21,0	10	250	0,68
VG425000	25x25	24,5	10	100	0,83
VG432000	32x32	28,0	10	70	1,24
VG440000	40x40	32,0	5	30	2,14
VG450000	50x50	39,0	5	20	4,75
VG463000	63x63	44,0	1	10	9,90
□ VG475000	75x75	73,0	1	20	16,00
□ VG490000	90x90	97,0	1	9	34,50
□ VG411000	110x110	120,0	1	6	51,00
★ □ VG412500 17111	125x125	77,0	1	5	75,00
★ ○ □ VG416000 17113/2	160x160 SDR 11	113,0	1	1	180,00
★ ○ □ VG400200 17115/2	200x200 SDR 11	127,0	1	1	520,00
★ ○ □ VG400250 17117/2	250x250 SDR 11	155,0	1	1	890,00

## Gomito maschio/femmina a 90°



Codice	Ø MxF mm.	L mm.	Conf. Pezzi	Conf. Scatola	€/Pz.
VG920010	20x20	20,0	10	250	0,68
VG925010	25x25	25,0	10	130	0,92

## Gomito filettato femmina a 90°

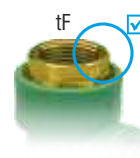

Codice	Ø mm.	tF	Conf. Pezzi	Conf. Scatola	€/Pz.
VGF20010	20	1/2"	10	100	3,30
VGF20020	20	3/4"	10	50	5,10
VGF25010	25	1/2"	10	70	4,70
VGF25020	25	3/4"	10	40	6,10
VGF32020	32	3/4"	10	30	7,50
VGF32030 <input checked="" type="checkbox"/>	32	1"	5	30	13,00

## Gomito filettato maschio a 90°



Codice	Ø mm.	tM	Conf. Pezzi	Conf. Scatola	€/Pz.
VGM20010	20	1/2"	10	100	4,00
VGM20020	20	3/4"	10	50	7,60
VGM25010	25	1/2"	10	50	6,60
VGM25020	25	3/4"	10	50	7,80
VGM32020	32	3/4"	10	40	16,00
VGM32030 <input checked="" type="checkbox"/>	32	1"	5	30	16,50

## Gomito maschio filettato femmina a 90°



Codice	Ø mm.	tF	Conf. Pezzi	Conf. Scatola	€/Pz.
VGF20110	20	1/2"	10	100	5,40

## Gomito filettato femmina a 90° con staffa



Codice	Ø mm.	tF	L mm.	Conf. Pezzi	Conf. Scatola	€/Pz.
VSF20010	20	1/2"	45,0	10	70	3,70

## Gomito filettato maschio a 90° con staffa



Codice	Ø mm.	tM	L mm.	Conf. Pezzi	Conf. Scatola	€/Pz.
VSM20010	20	1/2"	45,0	10	100	6,20

## Raccordo a T

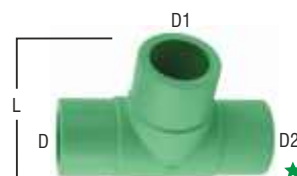

Codice	Ø Dx D1xD2 mm.	L mm.	Conf. Pezzi	Conf. Scatola	€/Pz.
VT202020	20x20x20	27,0	10	100	0,49
VT252525	25x25x25	32,0	10	100	0,72
VT323232	32x32x32	38,0	5	50	1,15
VT404040	40x40x40	45,0	1	20	2,85
VT505050	50x50x50	54,0	1	10	5,80
VT636363	63x63x63	63,0	1	10	10,50
VT757575	75x75x75	120,0	1	20	23,80
VT909090	90x90x90	142,5	1	10	41,00
VT111111	110x110x110	172,0	1	10	67,00
★ □ VT121212 17211	125x125x125	207,0	1	5	110,00
★ □ ○ VT161616 17213/2	160x160x160 SDR11	305,0	1	1	237,00
★ □ ○ VT202020 17215/2	200x200x200 SDR11	351,0	1	1	617,00
★ □ ○ VT252525 17217/2	250x250x250 SDR11	439,0	1	1	950,00

## Raccordo a T ridotto

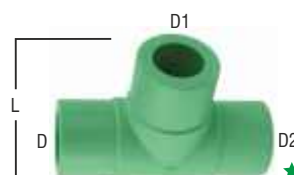
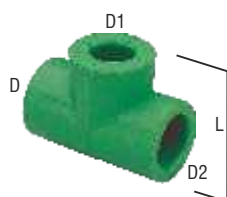

Codice	Ø Dx D1xD2 mm.	L mm.	Conf. Pezzi	Conf. Scatola	€/Pz.
VT252025	25x20x25	31,0	10	100	1,12
VT322032	32x20x32	35,0	5	50	1,32
VT322532	32x25x32	37,0	5	70	1,28
VT402540	40x25x40	43,0	1	20	4,56
VT403240	40x32x40	43,0	1	20	4,60
VT502550	50x25x50	54,0	1	10	8,00
VT503250	50x32x50	54,0	1	10	6,90
Vt504050	50x40x50	54,0	1	10	7,25
VT632563	63x25x63	63,0	1	15	11,80
VT633263	63x32x63	63,0	1	10	11,80
VT635063	63x50x63	63,0	1	10	11,80

## Raccordo a T ridotto

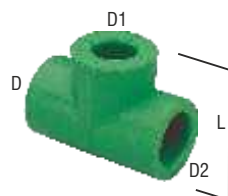

Codice	Ø DxD1xD2 mm.	L mm.	Conf. Pezzi	Conf. Scatola	€/Pz.
<input type="checkbox"/> VT753275	75x32x75	114,5	1	25	24,50
<input type="checkbox"/> VT754075	75x40x75	114,5	1	25	24,50
<input type="checkbox"/> VT755075	75x50x75	120,5	1	25	24,50
<input type="checkbox"/> VT756375	75x63x75	120,5	1	16	24,50
<input type="checkbox"/> VT905090	90x50x90	134,0	1	16	44,00
<input type="checkbox"/> VT906390	90x63x90	134,0	1	16	44,00
<input type="checkbox"/> VT907590	90x75x90	140,0	1	16	44,00
<input type="checkbox"/> VT110611	110x63x110	159,2	1	10	66,00
<input type="checkbox"/> VT110711	110x75x110	159,2	1	6	66,00
<input type="checkbox"/> VT110911	110x90x110	170,5	1	6	67,00
★ <input type="checkbox"/> VT121112 17420	125x110x125	193,0	1	6	142,00

## Raccordo a T filettato femmina

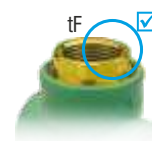

Codice	Ø mm.	tF	Conf. Pezzi	Conf. Scatola	€/Pz.
VTF20010	20x20	1/2"	10	70	4,25
VTF25010	25x25	1/2"	10	40	5,95
VTF25020	25x25	3/4"	10	40	6,60
VTF32020	32x32	3/4"	5	30	10,20
VTF32030 <input checked="" type="checkbox"/>	32x32	1"	5	20	14,20

## Raccordo a T filettato maschio



Codice	Ø mm.	tF	Conf. Pezzi	Conf. Scatola	€/Pz.
VTM20010	20x20	1/2"	10	100	6,00
VTM25010	25x25	1/2"	10	40	8,60
VTM25020	25x25	3/4"	10	40	9,90
VTM32020	32x32	3/4"	5	20	12,40
VTM32030 <input checked="" type="checkbox"/>	32x32	1"	5	20	17,60

## Manicotto



Codice	Ø mm.	L mm.	Conf. Pezzi	Conf. Scatola	€/Pz.
VMA20000	20x20	35,0	10	200	<b>0,39</b>
VMA25000	25x25	39,0	10	200	<b>0,59</b>
VMA32000	32x32	43,0	10	100	<b>0,87</b>
VMA40000	40x40	48,0	1	50	<b>2,30</b>
VMA50000	50x50	56,0	1	20	<b>3,26</b>
VMA63000	63x63	52,0	1	10	<b>5,90</b>
VMA75000	75x75	71,5	1	25	<b>11,40</b>
VMA90000	90x90	80,4	1	20	<b>22,50</b>
VMA11000	110x110	94,5	1	10	<b>32,00</b>
★ □ VMA12500 17011	125x125	91,0	1	12	<b>50,50</b>

## Giunto filettato femmina

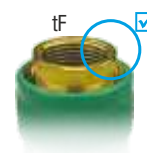

Codice	Ø mm.	tF	Conf. Pezzi	Conf. Scatola	€/Pz.
VMF20010	20	1/2"	10	100	<b>3,30</b>
VMF20020	20	3/4"	10	100	<b>5,90</b>
VMF25010	25	1/2"	10	100	<b>4,65</b>
VMF25020	25	3/4"	10	70	<b>4,95</b>
VMF32020	32	3/4"	10	20	<b>7,35</b>
VMF32030	32	1"	5	40	<b>11,30</b>
VMF40040	40	1" 1/4	1	30	<b>24,20</b>
VMF50050	50	1" 1/2	1	20	<b>26,50</b>
VMF63060	63	2"	1	15	<b>43,00</b>
□ VMF75070 <input checked="" type="checkbox"/>	75	2" 1/2	1	8	<b>143,00</b>

## Giunto filettato maschio



Codice	Ø mm.	tM	Conf. Pezzi	Conf. Scatola	€/Pz.
VMM20010	20	1/2"	10	100	<b>3,70</b>
VMM20020	20	3/4"	10	100	<b>7,60</b>
VMM25010	25	1/2"	10	100	<b>5,50</b>
VMM25020	25	3/4"	10	100	<b>6,40</b>
VMM32020	32	3/4"	10	40	<b>8,60</b>



## Giunto filettato maschio



Codice	Ø mm.	tM	Conf. Pezzi	Conf. Scatola	€/Pz.
VMM32030	32	1"	5	40	12,50
VMM40040	40	1" 1/4	1	20	25,50
VMM50050	50	1" 1/2	1	20	30,50
VMM63060	63	2"	1	15	47,00
<input type="checkbox"/> VMM75070 <input checked="" type="checkbox"/>	75	2" 1/2	1	8	108,00
<input type="checkbox"/> VMM90080 <input checked="" type="checkbox"/>	90	3"	1	5	152,00
<input type="checkbox"/> VMM11090 <input checked="" type="checkbox"/>	110	4"	1	5	255,00

## Riduzione maschio/femmina



Codice	Ø M mm.	Ø F mm.	L mm.	Conf. Pezzi	Conf. Scatola	€/Pz.
VRM25200	25	20	40,0	10	200	0,54
VRM32200	32	20	40,0	10	100	0,75
VRM32250	32	25	40,0	10	100	0,80
VRM40200	40	20	44,0	1	30	1,76
VRM40250	40	25	44,0	5	60	1,54
VRM40320	40	32	44,0	5	60	1,54
VRM50250	50	25	53,0	5	50	2,38
VRM50320	50	32	54,0	5	50	2,38
VRM50400	50	40	55,0	5	50	2,38
VRM63250	63	25	64,0	1	40	4,56
VRM63320	63	32	64,0	5	40	4,56
VRM63400	63	40	64,0	5	30	4,56
VRM63500	63	50	68,0	5	30	4,56
VRM75500	75	50	66,0	1	20	10,00
VRM75630	75	63	52,0	1	20	10,00
VRM90630	90	63	64,0	1	20	17,40
VRM90750	90	75	68,0	1	20	17,40
VRM11063	110	63	89,0	1	10	28,00
VRM11075	110	75	88,0	1	10	28,00
VRM11900	110	90	74,0	1	20	28,00
★ <input type="checkbox"/> VRM12110 17646	125	110 SDR11	89,0	1	15	29,00
★ <input type="checkbox"/> VRM16110 17647/2	160	110 SDR11	255,0	1	1	90,00
★ <input type="checkbox"/> VRM16125 17648/2	160	125 SDR11	260,0	1	1	90,00
★ <input type="checkbox"/> VRM20160 17650/2	200	160 SDR11	303,0	1	1	166,00
★ <input type="checkbox"/> VRM25160 17651/2	250	160 SDR11	339,0	1	1	227,00
★ <input type="checkbox"/> VRM25020 17652/2	250	200 SDR11	340,0	1	1	227,00

## Tappo a calotta



Codice	Ø mm.	Conf. Pezzi	Conf. Scatola	€/Pz.
VC200000	20	10	200	0,53
VC250000	25	10	150	0,58
VC320000	32	10	120	0,98
VC400000	40	1	100	2,62
VC500000	50	1	50	3,08
VC630000	63	1	10	6,12
VC750000	75	1	50	11,50
VC900000	90	1	30	18,80
VC110000	110	1	15	30,00
★ □ VC125000 17711	125	1	12	75,00
★ ○ □ VC160000 17712/2	160 SDR11	1	1	100,00
★ ○ □ VC000200 17713/2	200 SDR11	1	1	114,00
★ ○ □ VC000250 17714/2	250 SDR11	1	1	176,00

## Sorpasso maschio/maschio



Codice	Ø mm.	Conf. Pezzi	Conf. Scatola	€/Pz.
VS202000	20x20	10	150	2,30
VS202500	25x25	10	100	3,15
VS203200	32x32	5	50	4,40

## Sorpasso femmina/femmina



Codice	Ø mm.	Conf. Pezzi	Conf. Scatola	€/Pz.
VS2020FF	20x20	5	50	3,60

## Sorpasso corto femmina/femmina



Codice	Ø mm.	Conf. Pezzi	€/Pz.
VS2020FC	20x20	100	1,25
VS2025FC	25x25	100	2,20

Dima allineamento 150 mm.



Codice	Ø mm.	Conf. Pezzi	€/Pz.
VM020010	20x1/2"	25	8,70
VM025010	25x1/2"	20	9,50

Bocchettone dritto



Codice	Ø mm.	t	Conf. Pezzi	Conf. Scatola	€/Pz.
VMC20020	20	3/4"	5	100	9,70
VMC25020	25	3/4"	5	50	13,30
VMC32030	32	1"	5	50	24,60

Rubinetto a vitone con cappuccio



Codice	Ø mm.	t Ø mm.	Conf. Pezzi	Conf. Scatola	€/Pz.
VRB20000	20	75,0	1	20	15,50
VRB25000	25	75,0	1	20	18,00

Codice Ricambio	Descrizione	Conf. Pezzi	Conf. Scatola	€/Pz.
VRB00100	Vitone Ø 3/4"	1	-	7,10
VRB00500	Vitone Ø 1/2"	1	-	5,90
VRB00200	Rosone cromato	1	-	5,40
VRB00300	Cappuccio cromato	1	5	5,50
VRBVOLAN	Volantino	1	-	1,95
VRBVITEO	Vite per volantino	1	-	0,60
VRB00400	Prolunghe per vitone/cappuccio o maniglia Ø 1/2" e Ø 3/4"	1	-	8,80

Valvola a sfera con cappuccio



Codice	Ø mm.	t Ø mm.	Conf. Pezzi	Conf. Scatola	€/Pz.
VWS20000	20	75,0	1	20	25,00
VWS25000	25	75,0	1	20	27,00
VWS32000	32	75,0	1	20	33,00

## Rubinetto a vitone con maniglia



Codice	Ø mm.	t Ø mm.	Conf. Pezzi	Conf. Scatola	€/Pz.
VRB20010	20	75,0	1	20	20,50
VRB25010	25	75,0	1	20	23,00
VRB32010	32	75,0	1	20	27,00

Codice Ricambio	Descrizione	Conf. Pezzi	Conf. Scatola	€/Pz.
VRB00600	Vitone Ø 3/4" prolungato	1	-	9,10
VRB00011	Vitone Ø 1/2" prolungato	1	5	8,20
VRB00200	Rosone cromato	1	-	5,40
VRB00900	Cappuccio cromato con foro	1	5	5,00
VRB00700	Maniglia con vite	1	-	6,80
VRB00400	Prolunghe per vitone/cappuccio o maniglia Ø 1/2" e Ø 3/4"	1	-	8,80

## Valvola a sfera con maniglia



Codice	Ø mm.	t Ø mm.	Conf. Pezzi	Conf. Scatola	€/Pz.
VVS20010	20	75,0	1	20	31,00
VVS25010	25	75,0	1	20	33,00
VVS32010	32	75,0	1	20	40,00

Rubinetto **UNIVERSALE** con cappuccio per gamme BALPEX e GREENTHERM

Codice	Ø	t Ø mm.	Conf. Pezzi	€/Pz.
LPRB12CA	1/2"	75,0	20	*
LPRB34CA	3/4"	75,0	10	*

Codice Ricambio	Descrizione	Conf. Pezzi	Conf. Scatola	€/Pz.
LPVICA34	Vitone Ø 3/4"	1	5	*
LPVICA12	Vitone Ø 1/2"	1	5	*
LPRBR000	Rosone cromato	1	5	*
LPRBCACA	Cappuccio cromato	1	5	*
LPRBPROL	Prolunga per cappuccio Ø 1/2" e Ø 3/4"	1	5	*

\* Prezzo e sconto gamma BALPEX

## Valvola a sfera con leva



Codice	Ø mm.	t Ø mm.	Conf. Pezzi	Conf. Scatola	€/Pz.
VVS20040	20	75,0	1	20	22,00
VVS25040	25	75,0	1	20	26,00
VVS32040	32	75,0	1	20	38,00
VVS40040	40	75,0	1	20	58,00
VVS50040	50	75,0	1	10	90,00
VVS63040	63	75,0	1	10	119,00

## Collare a saldare

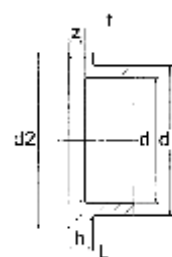

Codice	Ø mm.	D1 mm.	D2 mm.	L mm.	Z mm.	t mm.	h mm.	Conf. Pezzi	Conf. Scatola	€/Pz.
★ VCOL0063 17807	63,0	76,0	103,0	40,0	10,0	30,0	14,0	1	30	8,35
★ VCOL0075 17808	75,0	90,0	122,0	40,0	7,0	33,0	17,0	1	20	12,00
★ VCOL0090 17809	90,0	107,0	138,0	44,0	7,0	37,0	17,0	1	15	19,50
★ VCOL0110 17810	110,0	132,0	157,0	47,0	5,0	42,0	19,0	1	12	32,00
★ VCOL0125 17811	125,0	146,0	162,0	53,0	13,0	40,0	25,0	1	10	53,00
★ ○ □ VCOL0160 17812/2	160,0	SDR11	--	--	--	--	--	1	1	186,00
★ ○ □ VCOL0200 17814/2	200,0	SDR11	--	--	--	--	--	1	1	400,00
★ ○ □ VCOL0250 17816/2	250,0	SDR11	--	--	--	--	--	1	1	510,00

## Flangia 4/8 fori

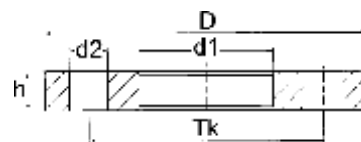

Codice	Ø d mm.	Ø DN mm.	Ø D mm.	D1 mm.	D2 mm.	Tk mm.	h mm.	Conf. Pezzi	€/Pz.
□ VFLA0063 14207	63,0	50,0	165,0	78,0	18,0	125,0	18,0	1	48,00
□ VFLA0075 14208	75,0	65,0	185,0	92,0	18,0	145,0	20,0	1	55,00
□ VFLA0090 14209	90,0	80,0	200,0	110,0	18,0	160,0	22,0	1	69,00
□ VFLA0110 14210	110,0	100,0	220,0	133,0	18,0	180,0	24,0	1	81,00
□ VFLA0125 14211	125,0	115,0	165,0	78,0	18,0	125,0	18,0	1	100,00
□ VFLA0160 14212	160,0	150,0	185,0	92,0	18,0	145,0	20,0	1	134,00
□ VFLA0200 14214	200,0	190,0	200,0	110,0	18,0	160,0	22,0	1	181,00
□ VFLA0250 14216	250,0	240,0	220,0	133,0	18,0	180,0	24,0	1	246,00

## Manicotto sella

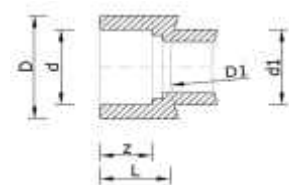

Codice		Ø D1 mm.	Ø d1 mm.	Ø D mm.	Ø d2 mm.	L mm.	z mm.	Conf. Pezzi	Conf. Scatola	€/Pz.
★ VMSE4020	17741	40	20	29	25,0	23,0	17,0	5	250	<b>1,90</b>
★ VMSE4025	17742	40	25	35	25,0	25,0	18,0	5	250	<b>1,90</b>
★ VMSE5020	17744	50	25	29	25,0	23,0	17,0	5	250	<b>1,90</b>
★ VMSE5025	17745	50	25	35	25,0	25,0	18,0	5	250	<b>1,90</b>
★ VMSE6320	17747	63	25	29	25,0	23,0	17,0	5	200	<b>2,35</b>
★ VMSE6325	17748	63	25	35	25,0	25,0	18,0	5	200	<b>2,35</b>
★ VMSE6332	17749	63	32	44	32,0	27,0	20,0	5	150	<b>2,35</b>
★ VMSE7520	17750	75	25	29	25,0	23,0	17,0	5	200	<b>2,35</b>
★ VMSE7525	17751	75	25	35	25,0	25,0	18,0	5	200	<b>2,35</b>
★ VMSE7532	17752	75	32	44	32,0	27,0	20,0	5	120	<b>2,35</b>
★ VMSE9020	17754	90	25	29	25,0	23,0	17,0	5	200	<b>2,60</b>
★ VMSE9025	17756	90	25	35	25,0	25,0	18,0	5	200	<b>2,60</b>
★ VMSE9032	17758	90	32	44	32,0	27,0	20,0	5	150	<b>2,60</b>
★ VMSE1120	17760	110	25	29	25,0	23,0	17,0	5	200	<b>2,60</b>
★ VMSE1125	17761	110	25	35	25,0	25,0	18,0	5	150	<b>2,60</b>
★ VMSE1132	17762	110	32	44	32,0	27,0	20,0	5	120	<b>2,60</b>
□ ★ VMSE1220	17765	125	25	29	25,0	23,0	17,0	5	200	<b>2,80</b>
□ ★ VMSE1225	17766	125	25	35	25,0	25,0	18,0	5	150	<b>2,80</b>
□ ★ VMSE1232	17767	125	32	44	32,0	27,0	20,0	5	100	<b>2,80</b>
□ ★ VMSE1620	17770	160-250/20	25	29	25,0	23,0	17,0	5	200	<b>2,80</b>
□ ★ VMSE1625	17771	160-250/25	25	35	25,0	25,0	18,0	5	200	<b>2,80</b>
□ ★ VMSE1632	17772	160-250/32	32	44	32,0	27,0	20,0	5	100	<b>2,80</b>
□ ★ VMSE1640	17773	160-250/40	40	53	40,0	30,0	21,0	5	100	<b>5,70</b>
□ ★ VMSE1650	17774	160-250/50	50	58	50,0	35,0	24,0	5	100	<b>9,50</b>
□ ★ VMSE1663	17775	160-250/63	63	85	63,0	40,0	28,0	1	50	<b>10,40</b>

## Manicotto sella filettato femmina

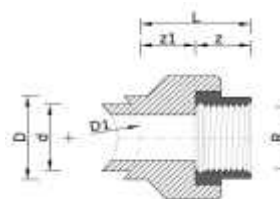

Codice		Ø D1 mm.	Ø R	Ø d mm.	L mm.	z mm.	z1 mm.	Conf. Pezzi	Conf. Scatola	€/Pz.
★ VSE40120	18352	40	1/2"	25,0	41,0	22,0	18,0	5	100	23,00
★ VSE40020	18353	40	3/4"	25,0	41,0	22,0	18,0	5	100	23,50
★ VSE50120	18354	50	1/2"	25,0	41,0	22,0	18,0	5	100	23,00
★ VSE50020	18355	50	3/4"	25,0	41,0	22,0	18,0	5	100	23,50
★ VSE63120	18356	63	1/2"	25,0	41,0	22,0	18,0	5	100	23,00
★ VSE63020	18357	63	3/4"	25,0	41,0	22,0	18,0	5	100	23,50
★ VSE63010	18358	63	1"	32,0	48,0	24,0	24,0	5	80	24,00
★ VSE75120	18359	75	1/2"	25,0	41,0	22,0	18,0	5	50	25,50
★ VSE75020	18360	75	3/4"	25,0	41,0	22,0	18,0	5	80	26,50
★ VSE75010	18361	75	1"	32,0	48,0	24,0	24,0	5	50	31,00
□ ★ VSE90120	18362	90	1/2"	25,0	41,0	22,0	18,0	5	80	24,00
□ ★ VSE90020	18363	90	3/4"	25,0	41,0	22,0	18,0	5	80	27,50
□ ★ VSE90010	18364	90	1"	32,0	48,0	24,0	24,0	5	50	34,50
□ ★ VSE11012	18366	110	1/2"	25,0	41,0	22,0	18,0	5	100	37,00
□ ★ VSE11020	18367	110	3/4"	25,0	41,0	22,0	18,0	5	80	38,50
□ ★ VSE11010	18368	110	1"	32,0	48,0	24,0	24,0	5	50	40,00
□ ★ VSE12512	18370	125	1/2"	25,0	41,0	22,0	18,0	5	50	46,50
□ ★ VSE12520	18371	125	3/4"	25,0	41,0	22,0	18,0	5	50	48,50
□ ★ VSE12510	18372	125	1"	32,0	48,0	24,0	24,0	5	50	50,00
□ ★ VSE16012	18375	160-250	1/2"	25,0	41,0	22,0	18,0	5	50	51,50
□ ★ VSE16020	18376	160-250	3/4"	25,0	41,0	22,0	18,0	5	50	52,00
□ ★ VSE16010	18377	160-250	1"	32,0	48,0	24,0	24,0	5	50	53,00





# Gamma **ACCESSORI e ATTREZZATURE** per sistemi in PP Random



## Tappo filettato maschio prova impianto



Codice	Aspetto	Ø	Conf. Pezzi	Conf. Scatola	€/Pz.
VTP20000B	BLU	1/2"	10	200	<b>0,62</b>
VTP20000R	ROSSO	1/2"	10	200	<b>0,62</b>
HL43.B	BLU	3/4"	10	--	*
HL43.R	ROSSO	3/4"	10	--	*

\* Prezzo e sconto gamma HL

## Saldamanicotti elettrici



Codice	Descrizione	Ø mm.	Conf. Pezzi	€/Pz.
VMA2011	Saldamanicotti elettrica per tubi GREENTHERM, POLYMELT ECOSAN e POLYMELT MECHANICAL completa di connettori universali da 4-4,7 mm. e lettore ottico scanner in bassa tensione 8/48 volt.	20/110	1	<b>2.400,00</b>

## Manicotto elettrico



Codice	Descrizione	Ø mm.	Conf. Pezzi	Conf. Scatola	€/Pz.
VME20000	Manicotto elettrico SDR 5 a saldare in bassa tensione 17/40 volt per tubi GREENTHERM, POLYMELT ECOSAN e POLYMELT MECHANICAL.	20	10	250	<b>18,00</b>
VME25000		25	10	200	<b>19,00</b>
VME32000		32	10	150	<b>22,00</b>
VME40000		40	5	100	<b>23,00</b>
VME50000		50	5	75	<b>24,00</b>
VME63000		63	5	50	<b>40,00</b>
VME75000		75	1	40	<b>45,00</b>
VME90000		90	1	24	<b>59,00</b>
VME11000		110	1	12	<b>97,00</b>
<input type="checkbox"/> VME12500	Manicotto elettrico SDR 7.4 a saldare in bassa tensione 8/48 volt per tubi GREENTHERM, POLYMELT ECOSAN e POLYMELT MECHANICAL.	125	1	1	<b>130,00</b>
<input type="checkbox"/> VME16000		160	1	1	<b>178,00</b>
<input type="checkbox"/> VME00200		200	1	1	<b>265,00</b>
<input type="checkbox"/> VME00250		250	1	1	<b>530,00</b>

## Cesoia tagliatubo



Codice	Ø mm.	Conf. Pezzi	€/Pz.
VVTA0100	16/40	1	<b>27,00</b>

## Cesoia tagliatubo



Codice	Ø mm.	Conf. Pezzi	€/Pz.
VVTA0200	50/140	1	275,00

## Polifusore per saldatura manuale



Codice	Ø mm.	Dotazione	Alimentazione	Potenza	Conf. Pezzi	€/Pz.
VVP10200	16/63	Con matrici Ø 20/25/32	220 V	800 W	1	310,00
VVP10300	16/125	Senza matrici	220 V	800 W	1	1.080,00

## Polifusore per saldatura manuale senza matrici



Codice	Ø mm.	Alimentazione	Potenza	Conf. Pezzi	€/Pz.
VVP00300	16/63	220 V	800 W	1	180,00

## Saldatrice per tubi compresa di valigia



Codice	Ø mm.	Dotazione	Alimentazione	Conf. Pezzi	€/Pz.
WVSE2012	20/125	Senza polifusore e matrici - Compresa di morse Ø 63-75-90-110-125 mm. - Utilizzabile solo con polifusore cod. VVP10300.	220 V	1	4.200,00

## Matrice



Codice	Ø mm.	Conf. Pezzi	€/Pz.
VPO2000	20	1	21,00
VPO2500	25	1	27,00
VPO3200	32	1	44,00
VPO4000	40	1	65,00
VPO5000	50	1	83,00
VPO6300	63	1	108,00
VPO7500	75	1	162,00
VPO9000	90	1	210,00
VPO1100	110	1	256,00
□ VPO1250	125	1	328,00

## Matrice riparafori



Codice	Ø mm.	Conf. Pezzi	€/Pz.
VPO0700	7	1	84,00
VPO0110	11	1	84,00

## Tappo riparafori



Codice	Applicabilità	Ø mm.	Conf. Pezzi	€/Pz.
VRF07000	GREENTHERM / POLYMELT ECOSAN / POLYMELT MECHANICAL	7/11	20	0,52

## Dima plastica di montaggio con tappi



Codice	Applicabilità	Conf. Pezzi	€/Pz.
VDIMAM00	GREENTHERM / POLYMELT ECOSAN / POLYMELT MECHANICAL	1	12,00

## Matrice sella



Codice	Applicabilità	Base	Ø mm.	Conf. Pezzi	€/Pz.
OVPO4025 15065	POLYMELT ECOSAN / POLYMELT MECHANICAL	(B25)	40	1	310,00
OVPO5025 15066	POLYMELT ECOSAN / POLYMELT MECHANICAL	(B25)	50	1	310,00
OVPO6325 15067	POLYMELT ECOSAN / POLYMELT MECHANICAL	(B25)	63	1	310,00
OVPO6332 15082	POLYMELT ECOSAN / POLYMELT MECHANICAL	(B32)	63	1	360,00
OVPO7525 15068	POLYMELT ECOSAN / POLYMELT MECHANICAL	(B25)	75	1	360,00
OVPO7532 15083	POLYMELT ECOSAN / POLYMELT MECHANICAL	(B32)	75	1	360,00
OVPO9025 15069	POLYMELT ECOSAN / POLYMELT MECHANICAL	(B25)	90	1	360,00
OVPO9032 15084	POLYMELT ECOSAN / POLYMELT MECHANICAL	(B32)	90	1	360,00
<input type="checkbox"/> OVPO1125 15070	POLYMELT ECOSAN / POLYMELT MECHANICAL	(B25)	110	1	360,00
<input type="checkbox"/> OVPO1132 15085	POLYMELT ECOSAN / POLYMELT MECHANICAL	(B32)	110	1	360,00
<input type="checkbox"/> OVPO1232 15086	POLYMELT ECOSAN / POLYMELT MECHANICAL	(B32)	125	1	380,00
<input type="checkbox"/> OVPO1632 15088	POLYMELT ECOSAN / POLYMELT MECHANICAL	(B32)	160	1	380,00
<input type="checkbox"/> OVPO1640 15106	POLYMELT ECOSAN / POLYMELT MECHANICAL	(B40)	160-250	1	380,00
<input type="checkbox"/> OVPO1650 15107	POLYMELT ECOSAN / POLYMELT MECHANICAL	(B50)	160-250	1	390,00
<input type="checkbox"/> OVPO1663 15108	POLYMELT ECOSAN / POLYMELT MECHANICAL	(B63)	160-250	1	460,00

## Base per punta per matrice sella



Codice	Applicabilità	Punta	Ø mm.	Conf. Pezzi	€/Pz.
OVVP2525 15095	POLYMELT ECOSAN / POLYMELT MECHANICAL	(B25)	25	1	350,00
OVVP3232 15096	POLYMELT ECOSAN / POLYMELT MECHANICAL	(B32)	32	1	370,00
<input type="checkbox"/> OVVP4040 15097	POLYMELT ECOSAN / POLYMELT MECHANICAL	(B40)	40	1	400,00
<input type="checkbox"/> OVVP5050 15098	POLYMELT ECOSAN / POLYMELT MECHANICAL	(B50)	50	1	430,00
<input type="checkbox"/> OVVP6363 15099	POLYMELT ECOSAN / POLYMELT MECHANICAL	(B63)	63	1	460,00

## Punta per base matrice sella



Codice	Applicabilità	Ø mm.	Conf. Pezzi	€/Pz.
OVVPUNTA 15094	POLYMELT ECOSAN / POLYMELT MECHANICAL	25	1	135,00

